

WATER/GAS PLAN
SCALE: 1/4" = 1'-0"

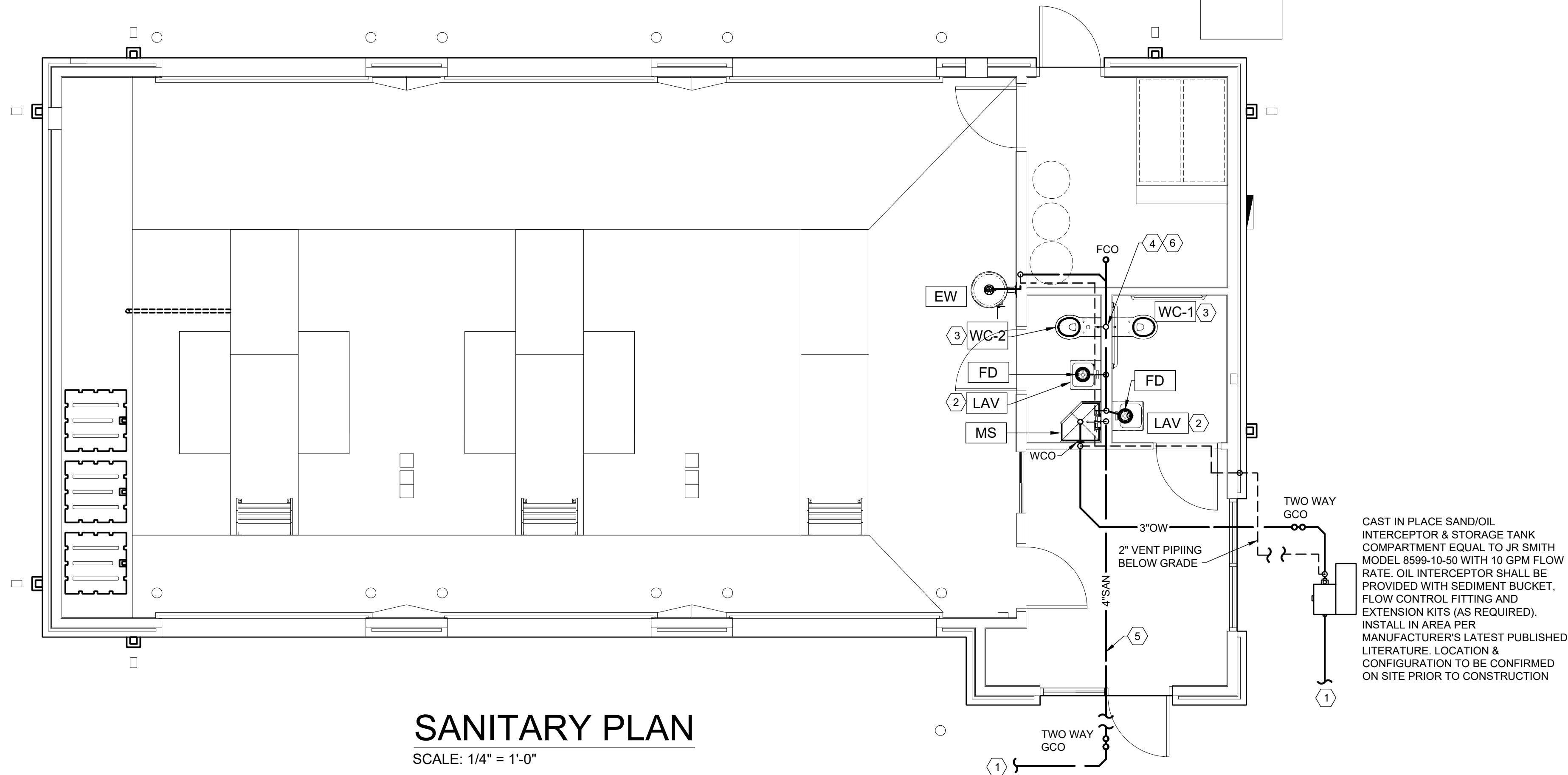

SANITARY PLAN
SCALE: 1/4" = 1'-0"

PLUMBING LEGEND

	SOIL OR WASTE PIPING ABOVE GRADE
	SOIL OR WASTE PIPING BELOW GRADE
	VENT PIPING
	COLD WATER PIPING
	HOT WATER PIPING
	BLOCK VALVE, SHUTOFF VALVE
	HOSE BIB HEIGHT AS NOTED
	PIPING DOWN
	CAP ON END OF PIPE
	FLOOR CLEANOUT
	BRANCH CONNECTION
	ASME TEMPERATURE & PRESSURE RELIEF VALVE
	VACUUM BREAKER
	KEYED NOTE REFERENCE

SANITARY - KEYED NOTES

- COORDINATE LOCATION OF EXISTING SANITARY SEWER LINE. FIELD VERIFY LOCATION. CONNECT NEW SANITARY PIPING SERVICE SEWER TO EXISTING.
- 2" WASTE DOWN 1 1/2" VENT UP FROM HAND LAVATORY
- 4" WASTE DOWN 2" VENT UP FROM WATER CLOSET
- ROUTE VENT UP THROUGH ROOF. COORDINATE WITH ARCHITECTURAL. ONLY ROUTE THRU WALLS THAT EXTEND TO DECK.
- MINIMUM SLOPE FOR SS/OW LINES TO BE 1/8" MINIMUM PER FOOT FOR 4" LINES 1/4" MINIMUM PER FOOT FOR 2", 3" & 4" LINES
- EXTEND 3"V THROUGH ROOF PROVIDE PIPE, BOOT AND COORDINATE WITH ROOFING SUBCONTRACTOR TO FLASH AND SEAL PENETRATION.

WATER/GAS - KEYED NOTES

- CONNECT NEW POTABLE WATER TO EXISTING WATER MAIN COORDINATED WITH CIVIL C-400.
- DROP 3/4" CW DOWN WALL & STUB OUT TO SERVE WATER CLOSET
- DROP 1/2" HW/CW DOWN WALL & STUB OUT TO SERVE LAVATORIES
- NOT USED.
- NEW 1 1/2" UNDERGROUND MAIN FROM CITY WATER SUPPLY. REFER TO CIVIL PLANS FOR METER, BACKFLOW PREVENTION AND ISOLATION TO BUILDING.
- WALL MOUNTED EMERGENCY EYE WASH. INSTALL AT MANUFACTURER'S RECOMMENDED HEIGHT.
- EMERGENCY FIXTURE THERMOSTATIC MIXING VALVE LOCATED INSIDE VALVE BOX ON WALL. ROUTE 1/2" CW & 1/2" HW TO MIXING VALVE. THEN EXTEND 1/2" TW (TEPID WATER 75°F) TO FIXTURE.
- AT PUBLIC HANDWASHING LAVATORY, PROVIDE ASSE 1070 APPROVED POINT OF USE MIXING VALVE. SET VALVE OUTLET TEMP TO 110°F.

PLUMBING NOTES

- THE CONTRACTOR INSTALL THE WORK IN ACCORDANCE WITH ALL LOCAL, STATE AND NATIONAL CODES, APPLICABLE REGULATIONS AND ORDINANCES.
- ALL WORK SHALL BE DONE IN A NEAT, PROFESSIONAL MANNER, BY COMPETENT, LICENSED TRADESMEN.
- THE CONTRACTOR WILL BE RESPONSIBLE FOR PAYING FOR ALL PERMITS AND OBTAINING ALL APPROVALS FROM THE AUTHORITY HAVING JURISDICTION.
- CONTRACTOR SHALL FURNISH AND INSTALL A COMPLETE SYSTEM, AS DESCRIBED IN THE DRAWINGS AND SPECIFICATIONS AND ANY OTHER MEANS BY THE OWNER'S REPRESENTATIVE.
- ALL MATERIALS USED UNDER THIS CONTRACT TO BE NEW, UL APPROVED AND IN GOOD WORKING ORDER.
- ALL WATER PIPING SYSTEMS SHALL BE VALVED AT THE INLET SIDE OF ALL EQUIPMENT, WITH HOT AND COLD WATER CONNECTIONS AND THE OUTLET SIDE OF ALL HOT WATER AND STEAM CONNECTIONS.
- ALL OPEN PIPING SHALL BE CAPPED OR PLUGGED TO PREVENT ENTRY OF FOREIGN MATERIAL DURING THE CONSTRUCTION PERIOD.
- ALL PIPING SHALL BE SECURED OR FASTENED TO STRUCTURAL FRAMING, WALLS OR STUDS.
- PIPING SHALL NOT CONTACT ANY ELECTRICAL CONDUITS DIRECTLY, OR INDIRECTLY THROUGH PIPE SUPPORTS.
- ALL WATER PIPING SHALL BE TYPE "L" COPPER TUBING, ASTM B-88 WITH WROUGHT COPPER FITTINGS, ANSI B-16.22. UNDERGROUND PIPING INSTALLED WITHIN SPECIALTY PRODUCTS CO. "PLASTI-SLEEVE", 0.005" THICKNESS.
- UNIT TRAPS, GREASE TRAPS, BACK FLOW PREVENTORS, AND OTHER EQUIPMENT DEEMED NECESSARY OR REQUIRED BY CODES OR LANDLORD, SHALL BE FURNISHED AND INSTALLED BY THE CONTRACTOR.
- ALL DOMESTIC HOT WATER PIPING SHALL BE INSULATED WITH FORMED STYROFOAM PIPE INSULATION. MINIMUM INSULATION THICKNESS SHALL BE 1".
- PRIOR TO COMMENCING WORK, CONTRACTOR TO CONFIRM LOCATION OF ALL FLOOR SINKS, FLOOR DRAINS WITH TENANT.

PLUMBING SPECIFICATIONS

- INSPECTIONS: THE CONTRACTOR MUST AT ALL TIMES LEND ANY ASSISTANCE NECESSARY FOR ENGINEERS OR THEIR AUTHORIZED REPRESENTATIVE TO MAKE TESTS, INSPECTIONS, ETC.
- BLOWING OUT, CLEANING AND TESTING SYSTEMS: ALL PIPING AND EQUIPMENT SHALL BE BLOWN OUT UNDER PRESSURE AND CLEANED OF FOREIGN MATTER BEFORE THE SYSTEM IS PUT INTO OPERATION. EQUIPMENT SHALL NOT BE CONNECTED TO PIPING UNTIL IT HAS BEEN BLOWN OUT AND CLEANED. PRESSURE TEST ALL NEW WATER PIPING SYSTEMS. ANY DEFECTS MADE EVIDENT BY THE TEST SHALL BE CORRECTED BY THIS CONTRACTOR WITHOUT EXTRA COST TO THE OWNER. DISINFECT WATER PIPING IN ACCORDANCE WITH THE AUTHORITY HAVING JURISDICTION. PLUMBING CODE.
- SANITARY WASTE AND VENT PIPING: PVC DWV PIPE AND FITTINGS CONFORMING TO ASTM-D2665.
- DOMESTIC WATER PIPING: ABOVE GROUND WATER TYPE L HARD COPPER WATER PIPING CONFORMING TO ASTM-B-88. WROUGHT COPPER FITTINGS CONFORMING TO ASTM-B-16.23.
- COMPRESSED AIR PIPING: THREADED BLACK STEEL PIPE AND FITTINGS.
- WASTE OIL PIPING (HARD PIPE): PRESSURE RATED PVC PIPE AND FITTINGS.
- WASTE OIL PIPING (HOSES): REFER TO FF&E MANUAL FOR REQUIRED HOSES. P.C. TO FIELD MEASURE LENGTH REQUIRED.
- WASHER FLUID DISTRIBUTION PIPING: CHARLOTTE PIPE "CHEM-DRAIN" CPVC PIPE AND FITTINGS OR APPROVED EQUAL.
- ANTI-FREEZE DISTRIBUTION PIPING: CHARLOTTE PIPE "CHEM-DRAIN" CPVC PIPE AND FITTINGS OR APPROVED EQUAL.
- INSULATION: ALL ABOVE GROUND DOMESTIC WATER PIPING SHALL BE WRAPPED WITH "1" FIBERGLASS INSULATION WITH PAPER JACKET. ALL EXPOSED PIPING IN ROOM 104 SHALL HAVE PVC JACKET OVER INSULATION.
- PROVIDE BALL VALVES TO ISOLATE ALL GROUPS OF FIXTURES AS SHOWN ON THE PLANS TO FACILITATE FUTURE SERVICING.
- PROVIDE DIELECTRIC UNIONS OR FLANGES TO ISOLATE DISSIMILAR METALS.
- ALL PIPING IN EXPOSED AREAS SHALL BE LABELED WITH PREFAB LABELS AND INCLUDE DIRECTION OF FLOW ARROWS
- HORIZONTAL DRAINAGE PIPING "3" AND LARGER SHALL HAVE A MINIMUM FALL OF 1/8" PER FOOT AN PIPING 2" AND SMALLER SHALL HAVE A MINIMUM FALL OF 1/4" PER FOOT. FIELD VERIFY INVERTS PRIOR TO CONSTRUCTION.
- CLEANOUTS SHALL BE PROVIDED IN ALL PIPING AS SHOWN OR INDICATED BY THE AUTHORITY HAVING JURISDICTION.
- WALL CLEANOUTS SHALL HAVE STAINLESS STEEL COVERS.
- ALL VENT PIPING SHALL SLOPE UP TO THE POINT OF DISCHARGE AT MINIMUM 1/16" PER FOOT.
- P.C. SHALL COORDINATE ALL FLOOR CUTTING WITH GC.
- REFER TO FF&E FOR ALL EQUIPMENT TO BE INSTALLED BY CONTRACTOR.



2022-01-26

JOHN FRANZ
architect

(817) 737-9922

4055 International Plaza Suite 100
Fort Worth, Texas 76109

STRICKLAND BROTHERS

TBD HWY 53
DAWSONVILLE, GA 30534

Revisions:

File Name: 22047
Project No: 22047
Date: 01/05/22
Drawn By: NH
Checked By: NH/DN
GC

SHEET

P1.0
PLUMBING
WATER AND
SANITARY
PLAN