

BLUFFTON
GATEWAY

S.C. HWY. 46 (BLUFFTON)

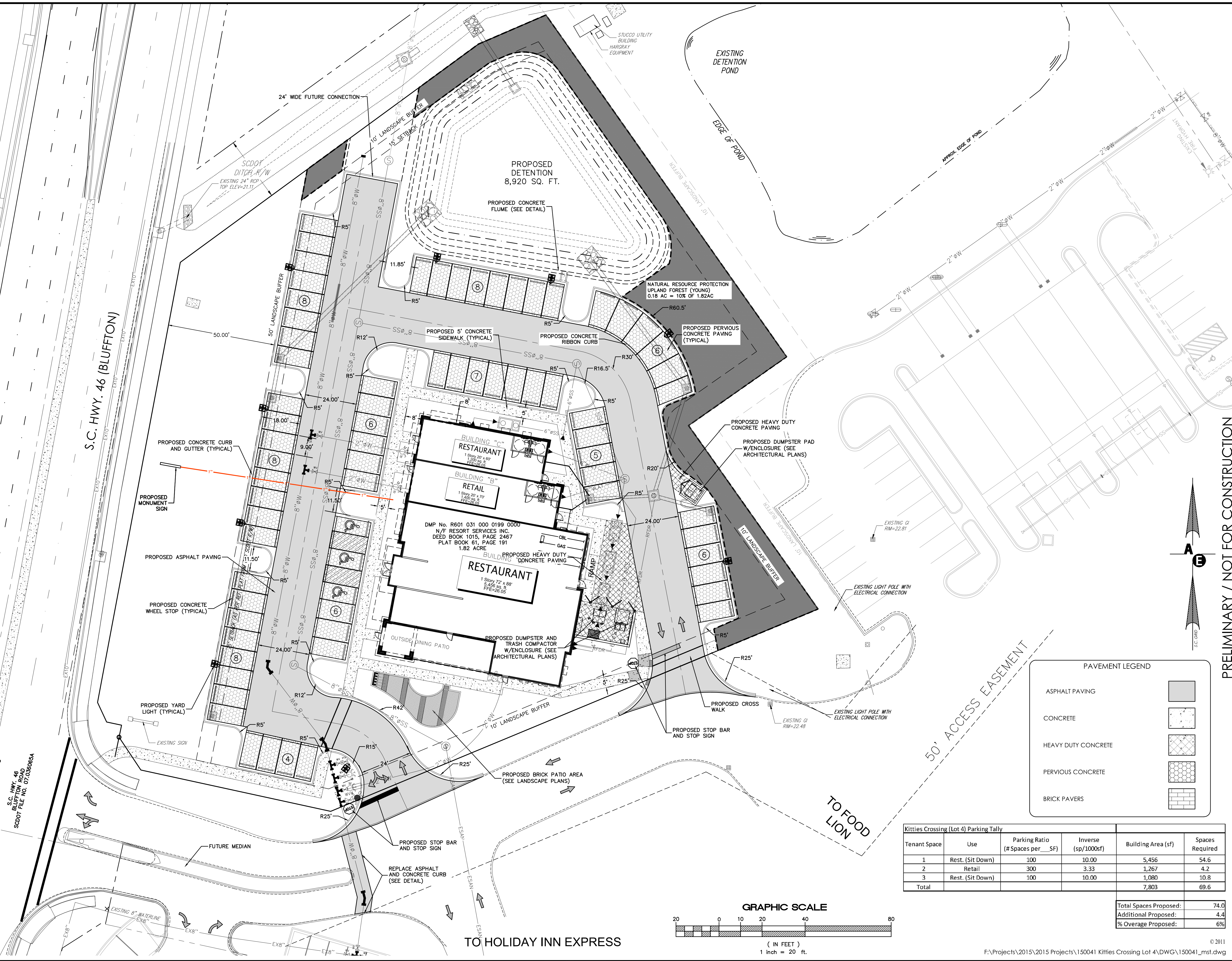

PRELIMINARY / NOT FOR CONSTRUCTION

PAVEMENT LEGEND	
ASPHALT PAVING	
CONCRETE	
HEAVY DUTY CONCRETE	
PERVIOUS CONCRETE	
BRICK PAVERS	

Kitties Crossing (Lot 4) Parking Tally					
Tenant Space	Use	Parking Ratio (# Spaces per ___ SF)	Inverse (sp/1000sf)	Building Area (sf)	Spaces Required
1	Rest. (Sit Down)	100	10.00	5,456	54.6
2	Retail	300	3.33	1,267	4.2
3	Rest. (Sit Down)	100	10.00	1,080	10.8
Total				7,803	69.6
				Total Spaces Proposed:	74.0
				Additional Proposed:	4.4
				% Overage Proposed:	6%

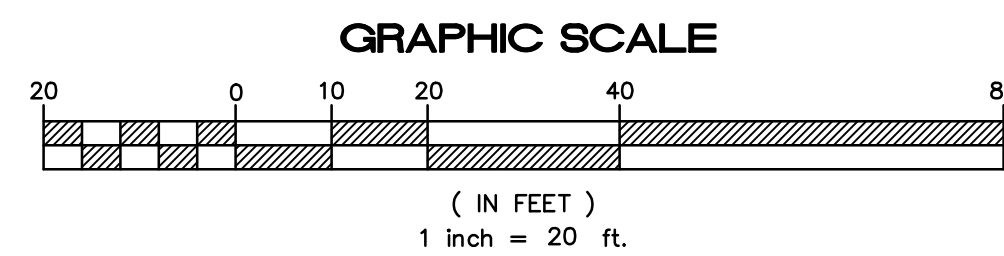

PLAN REVISIONS			
NO.	DESCRIPTION:	DATE:	BY:
1	RELOCATED NRPA PER SRT	12/21/16	RL
2	ROTATE DUMPSTER ENCLOSURE	01/11/17	RL
3	REVISE LS ISLANDS PER DRB	01/12/17	RL
4	REVISED PATIO PER LS ARCH.	03/01/17	RC
5			
6			
7			
8			

THE DESIGNS AND IDEAS PRESENTED IN THESE DRAWINGS ARE THE COPYRIGHTED PROPERTY OF ANDREWS ENGINEERING CO., INC. THE USE OR REPRODUCTION OF THESE PLANS OR THEIR CONTENT IS STRICTLY PROHIBITED WITHOUT PRIOR WRITTEN CONSENT.

Andrews Engineering & Surveying
Professional Engineer
No. 000000
State of South Carolina

2712 Bull Street Suite A
Beaufort, SC 29902
843.755.2223
Fax 843.755.2223

Andrews Engineering & Surveying

Preliminary Site Plan
For
Kitties Crossing Lot 4
S.C. Hwy. 46
Town of Bluffton
Beaufort County, SC

Horizontal Control
Plan

Date Drawn: 07/30/15
Last Revised: 03/01/17
Drawn By: R. Lyle
Engineer: S. Andrews

SHEET #:
6

JOB: 150041