

# CORNER RECORD

Agency Index

BK 98 PG-25

Document Number

CR 10207

City of San LorenzoCounty of Alameda

, California

Brief Legal Description

Mon @ Channel St & Via Manzanitas

## CORNER TYPE

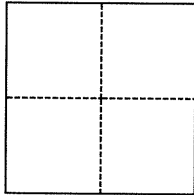

- ☐ Government Corner ☒ Control  
☐ Meander ☐ Property  
☐ Rancho ☐ Other

Date of Survey 5 28 17

## COORDINATES (Optional)

N. 2070843.93 E 6187617.90Elevation       

Units

☐ Metric☒ U.S. Survey FootHorizontal Datum       Zone 3Epoch Date       Vertical Datum       ☐ Complies with Public Resources Code §§8801-8819☐ Complies with Public Resources Code §§8890-8902

PLS Act Ref.:

☐ 8765(d)☒ 8771☐ 8773☐ Other:Corner/  
Monument:☒ Left as found☐ Established☐ Rebuilt☒ Pre-Construction☐ Found and tagged☐ Reestablished☐ Referenced☐ Post-Construction

Narrative of corner identified and monument as found, set, reset, replaced, or removed:

☐ See sheet #2 for description(s):City Monument

## SURVEYOR'S STATEMENT

This Corner Record was prepared by me or under my direction in conformance with

the Professional Land Surveyors' Act on

Signed

Joseph M. Brajkovich 6-4-17

P.L.S. or R.C.E. No.

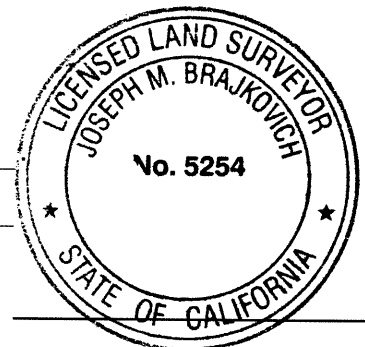
5254

## COUNTY SURVEYOR'S STATEMENT

This Corner Record was received

23 JUNE, 2017

and examined and filed

8 AUGUST, 2017

Signed

Michael Rubner

P.L.S. or R.C.E. No.

6843

Title

COUNTY SURVEYOR

County Surveyor's Comment

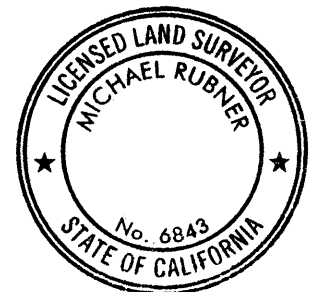

LEGEND

● MONUMENT

○ CUT X

REF.  
NORTH  
1" = 20'

