

CORNER RECORD

Agency Index

BK 103 PG 23

Document Number

CR 10675City of San Leandro County of Alameda, CaliforniaBrief Legal Description Lot 10, Block 1, Tract 704, filed in Bk. 11 Maps, at Pg. 16

CORNER TYPE

COORDINATES (Optional)

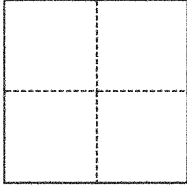

- ☐ Government Corner ☐ Control
☐ Meander ☒ Property
☐ Rancho ☐ Other

Date of Survey September 1, 2017

N. _____ E. _____

Elevation _____

Units

☐ Metric☐ U.S. Survey Foot

Horizontal Datum _____

Zone _____

Epoch Date _____

Vertical Datum _____

☐ Complies with Public Resources Code §§8801-8819☐ Complies with Public Resources Code §§8890-8902

PLS Act Ref.:

☒ 8765(d)☐ 8771☐ 8773☐ Other:Corner/
Monument:☐ Left as found☒ Established☐ Rebuilt☐ Pre-Construction☐ Found and tagged☐ Reestablished☐ Referenced☐ Post-Construction

Narrative of corner identified and monument as found, set, reset, replaced, or removed:

☒ See sheet #2 for description(s):**FOUND:** Standard county pin monuments in monument wells, per (11 Maps 16)**SET:** Nail with 3/4" brass tag "PLS 7393", and 1/2" rebar & plastic cap "PLS 7393"

SURVEYOR'S STATEMENT

This Corner Record was prepared by me or under my direction in conformance with

the Professional Land Surveyors' Act on October 3, 2017

Signed

P.L.S. or R.C.E. No.

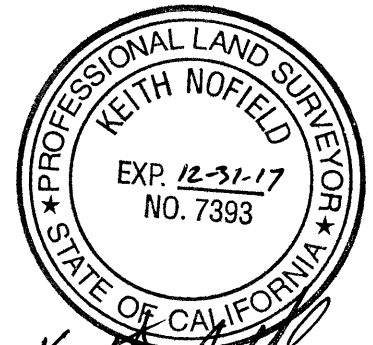
PLS 7393

COUNTY SURVEYOR'S STATEMENT

This Corner Record was received

4 OCTOBER 2017

and examined and filed

6 NOVEMBER

Signed

P.L.S. or R.C.E. No.

6843

Title

COUNTY SURVEYOR

County Surveyor's Comment



