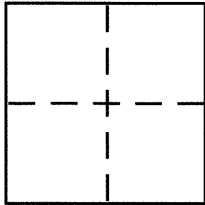

**CORNER RECORD**Document Number CR 9027City of San Leandro County of Alameda, CaliforniaBrief Legal Description Monument @ Clark St & 139th Ave**CORNER TYPE**

Government Corner ☐ Control ☒  
 Meander ☐ Property ☐  
 Rancho ☐ Other ☐  
 Date of Survey 10 01 16

**COORDINATES (Optional)**

N. 2087273.551  
 E. 2007417.444  
 Zone 3 NAD27 ☐ NAD83 ☒  
 NAD83 Epoch \_\_\_\_\_  
 Elev. \_\_\_\_\_  
 Vert. Datum: NGVD29 ☐ NAVD88 ☐  
 Meas. Units: Metric ☐ Imperial ☒

Corner - Left as found ☒ Found and tagged ☐ Established ☐ Reestablished ☐ Rebuilt ☐

Identification and type of corner found: Evidence used to identify or procedure used to establish or reestablish the corner:

Per section 8771b of the Business and  
professions code  
This monument was referenced after a  
construction project in the vicinity  
Referenced "Prior Construction CR 8116 bk 77 pg 72"

A description of the physical condition of the monument as found and as set or reset:

Found in good condition

**SURVEYOR'S STATEMENT**

This Corner Record was prepared by me or under my direction in conformance with  
 the Land Surveyor's Act on 10/7/2016

Signed Joseph Krajcar P.L.S or R.C.E. No. 5254

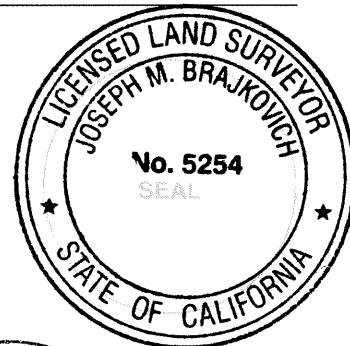
**COUNTY SURVEYOR'S STATEMENT**

This Corner Record was received 6 OCTOBER, 2016

and examined and filed 31 OCTOBER, 2016

Signed Michael Rubner P.L.S or R.C.E. No. 6843

Title COUNTY SURVEYOR

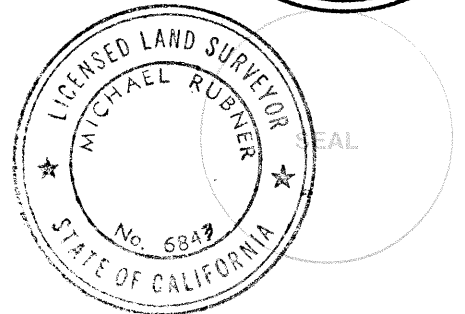

County Surveyor's Comment \_\_\_\_\_

REF.  
NORTH  
1"=10'

LARK STREET

N24°09'17"W  
31.82

ET 2452

MONUMENT

41.84  
S74°46'04"W

139TH AVENUE

N61°29'28"E  
39.68

LEGEND

● MONUMENT

○ CUT X